

REPLACEMENT PARTS LIST

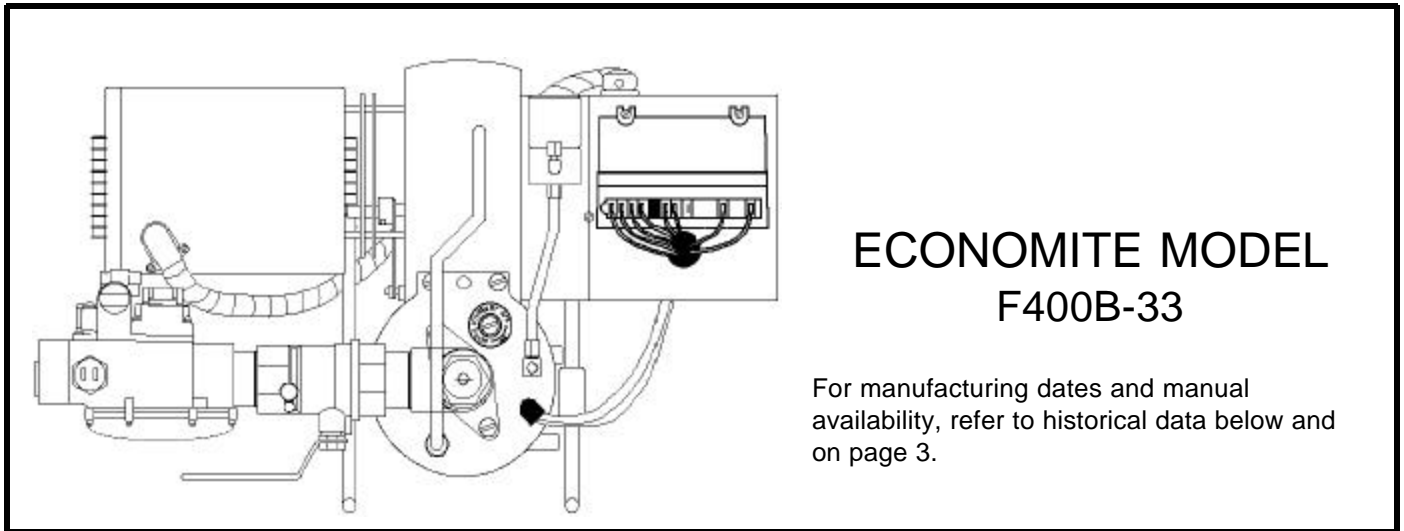

Manual:

F400B-33 Installation and Service Manual (8470-73)

- First production April 1994 (date code 1594).

IMPORTANT: Availability of parts as well as specifications are subject to change without notice. Please consult factory for item availability.

AVOID ERROR IN PARTS SELECTION. When ordering use complete MIDCO Part Number and Description. Furnish burner model number, bill of material number and date code from specification plate.



Midco International Inc.

4140 WEST VICTORIA STREET, CHICAGO, ILLINOIS 60646 (773) 604-8700 FAX: (773) 604-4070
www.midco-intl.com e-mail sales@midco-intl .com

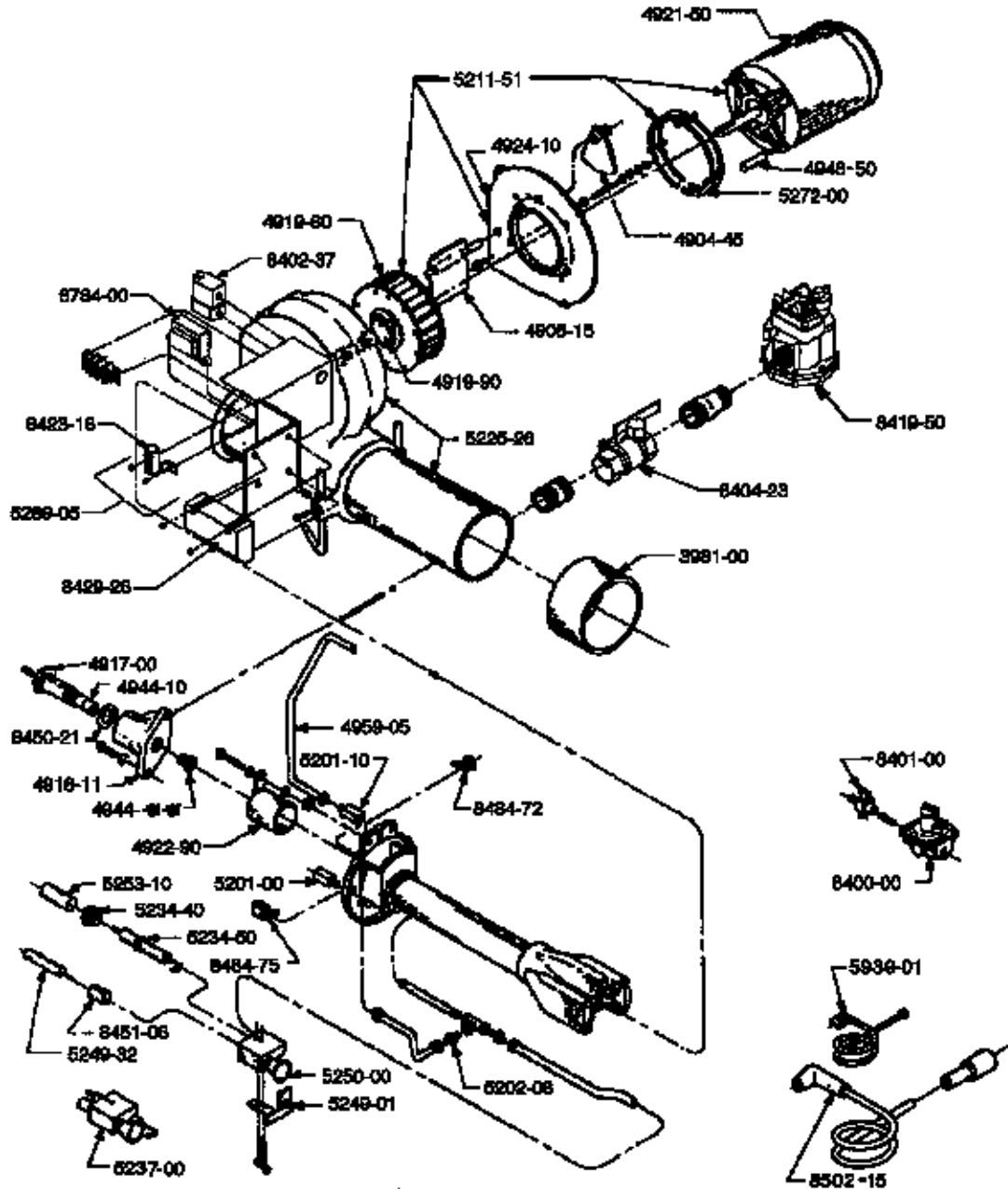

LAYOUT MAY NOT BE AS SHOWN

AVOID ERROR IN PARTS SELECTION. When ordering use complete MIDCO Part Number and Description. Furnish burner model number, bill of material number and date code (if available) from rating plate.

PART NO.	DESCRIPTION	PART NO.	DESCRIPTION
3981-00	4" Diameter Stainless Sleeve	5253-10	PVC Tubing—7¼16" I.D. x 2" long
4904-45	Quadrant—Air Shutter Adjustment	5269-05	Blower Interlock Switch (MICRO Switch) with Bracket
4905-15	Air Shutter—Internal	5272-00	Blower Inlet Grille
4917-00	Main Orifice Holder	5939-01	Flamerod Wire—5" through 9" Burner Tube
4918-11	Orifice Elbow (1"NPT)	6784-00	Transformer Assembly 120/1/60 24V-40VA
4919-60	Blower Wheel with Centrifugal Actuator and Disc	8400-00	1¼8" NPT Pilot Regulator—1 PSI maximum inlet (Maxitrol RV12)
4919-90	Centrifugal Actuator Disc	8401-00	1¼8" NPT Pilot "B" Cock
4921-50	1¼6 HP Motor	8402-37	1¼8" NPT Pilot Solenoid 24/1/60
4922-90	Primary Air Shutter Kit	8404-23	1" Ball Valve with side tap
4924-10	Inlet Side Plate	8406-69*	Motor Relay Single Pole 24V-14AMP (O.E.M. only)
4944-02	Main Spud 25¼64" drill (.390) minimum capacity— NATURAL—drill 7¼16" (.437) for 400/540 MBH range and omit for 540/700 range	8419-501	1" Redundant Combination/Pilot Valve (Robert Shaw)
4944-07	Main Spud #9 drill (.196) minimum capacity— PROPANE—drill for desired capacity per manual	8423-16	Blower Interlock Switch (MICRO BZ-2RQ174-A2)
4944-10	Main Spud Extension	8429-26	Electronic Control (M-H S8680J1004)
4948-50	Motor Spacer (4 required)	8470-73*	Installation and Service manual
4959-05	External Pilot Air Tube Kit	8450-21	Orifice Holder Sealing Gasket
5201-00	1¼2" sq. Pass Thru for 1¼4" Tube Fitting (gas line)	8451-06	Spark Rod Insulator sleeve
5201-10	1¼2" sq. Pass Thru for 5¼16" Tube Fitting (air line)	8484-72	Heyco Strain Relief (SR-4K-1)—Flame Rod Wire
5202-08	Pilot Spud #55 (.052) Drill [was #54 (.055)]— NATURAL and PROPANE	8484-75	Heyco Strain Relief (SR-11-2)—Spark Rod Wire
5211-51	Motor, Wheel and Side Plate Assembly 120¼1¼60	8502-15	Wire Assembly
5212-20*	Cartridge Assembly	8509-05*	Spark Cable (O.E.M. Thermo-cycler)
5214-20*	Cartridge Assembly (O.E.M. Thermo-cycler)	2020100*	4" Mounting Flange
5225-26	Blower Housing and Burner Tube Assembly	2020400*	4" long Accessory Blast Tube Extension
5234-40	Flamerod Gland Nut	2020500*	8" long Accessory Blast Tube Extension
5234-50	Flamerod Assembly	2030302*	Kit to convert NATURAL burner to PROPANE; includes minimum spud to be drilled per manual, Pilot Regulator Spring, Propane Regulator Head and Instructions.
5237-00	Pilot Assembly with Insulators, Rods, Temflex and Baffle		
5249-01	Pilot Air Baffle		
5249-32	Spark Rod Assembly		
5250-00	Pilot Tip with Cone less Insulators, Rods, Temflex and Baffle		

* NOT SHOWN

NOTES

1. **WARNING:** Explosion hazard. Can cause serious injury or death. This device can malfunction if it gets wet. Never try to use a device that has been wet—replace it.